

# 289 ENTERPRISE DRIVE, BRISTOL, CT



## FOR LEASE: 3,500 SF **FREE STANDING RESTAURANT**

Excellent opportunity located at the entrance to Lake Compounce and across the street from ESPN Headquarters.

- » High Visibility
- » Located on a busy road
- » Great signage

### AREA RETAILERS:

**AND  
MANY  
MORE!**

### DEMOGRAPHICS

	1-Mile	3-Miles	5-Miles
Population	4,326	54,488	123,592
Number of Household	2,160	23,760	52,441
Avg. Household Income	\$91,942	\$104,704	\$119,224

**20,470± ADT**

**A TRUE EXCLUSIVE...**  
**CALL FOR THE  
DETAILS!**

**AGENT:**  
**RICHARD SCHNIDER**  
203.762.6173  
rs@truecre.com

This information provided in this marketing package has been obtained from sources believed reliable, but has not been verified for accuracy or completeness. You should conduct a careful, independent investigation of the property and verify all information. Any reliance on this information is solely at your own risk.

**TRUE**  
COMMERCIAL REAL ESTATE LLC





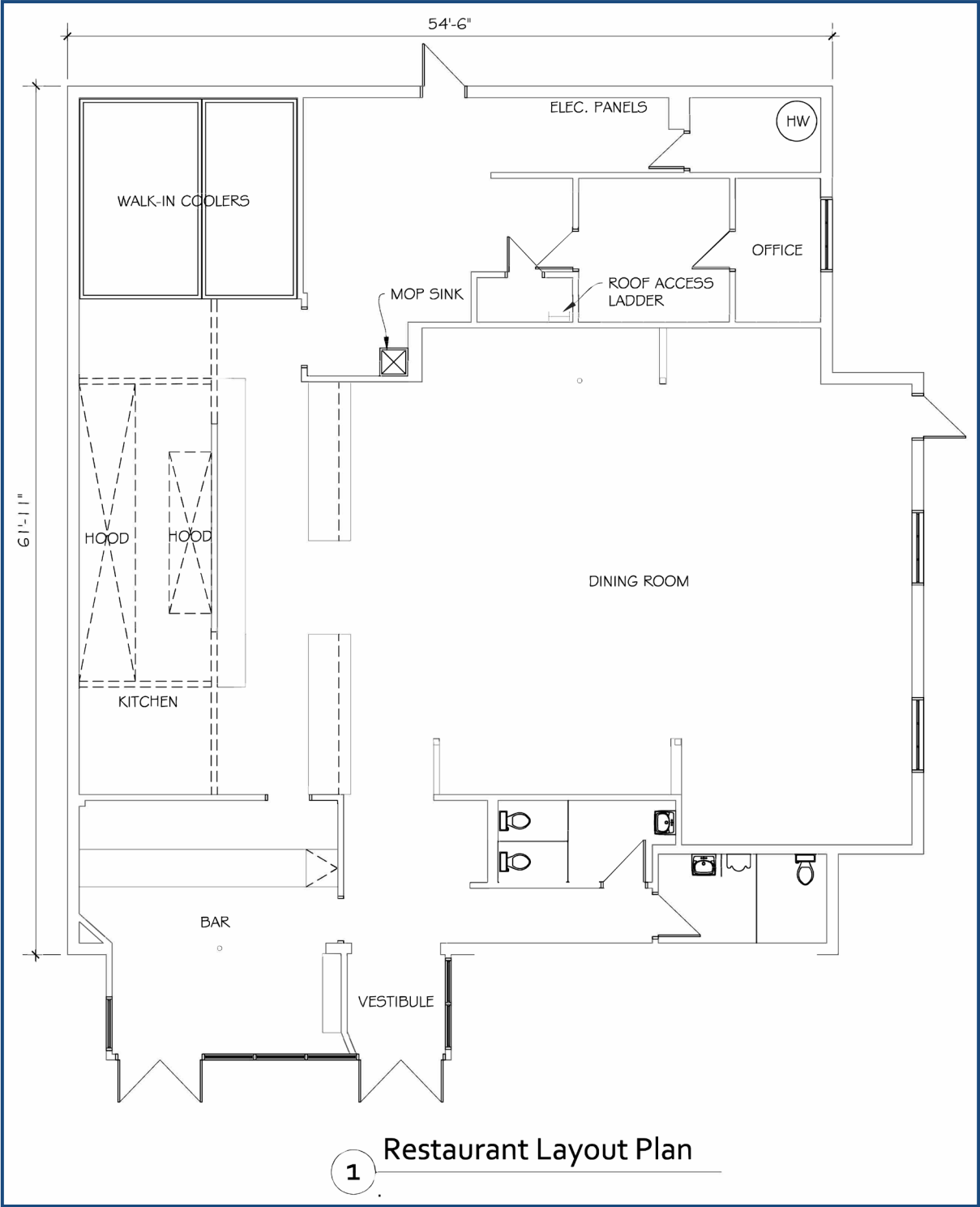

Restaurant Layout Plan



289 ENTERPRISE DRIVE, BRISTOL, CT

FORESTVILLE COMMONS



RK QUEEN PLAZA

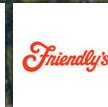

SOUTHINGTON CENTER



TRUE  
COMMERCIAL REAL ESTATE LLC