

# 311 E MAIN STREET, MIDDLETOWN, CT



## FOR LEASE: 14,820 SF

- » Excellent neighborhood location at a key intersection in the City.
- » Strong visibility and presence on East Main Street.
- » Sublease expires on **June 30, 2035**

### AREA RETAILERS:



### DEMOGRAPHICS

	1-Mile	3-Miles	5-Miles
Population	10,004	38,143	68,330
Number of Household	3,876	15,673	29,226
Avg. Household Income	\$99,628	\$102,090	\$113,586

**A TRUE EXCLUSIVE...**  
**CALL FOR THE  
DETAILS!**

**AGENT:**  
**DOMINICK MUSILLI**  
203.529.4629  
dm@truecre.com

This information provided in this marketing package has been obtained from sources believed reliable, but has not been verified for accuracy or completeness. You should conduct a careful, independent investigation of the property and verify all information. Any reliance on this information is solely at your own risk.



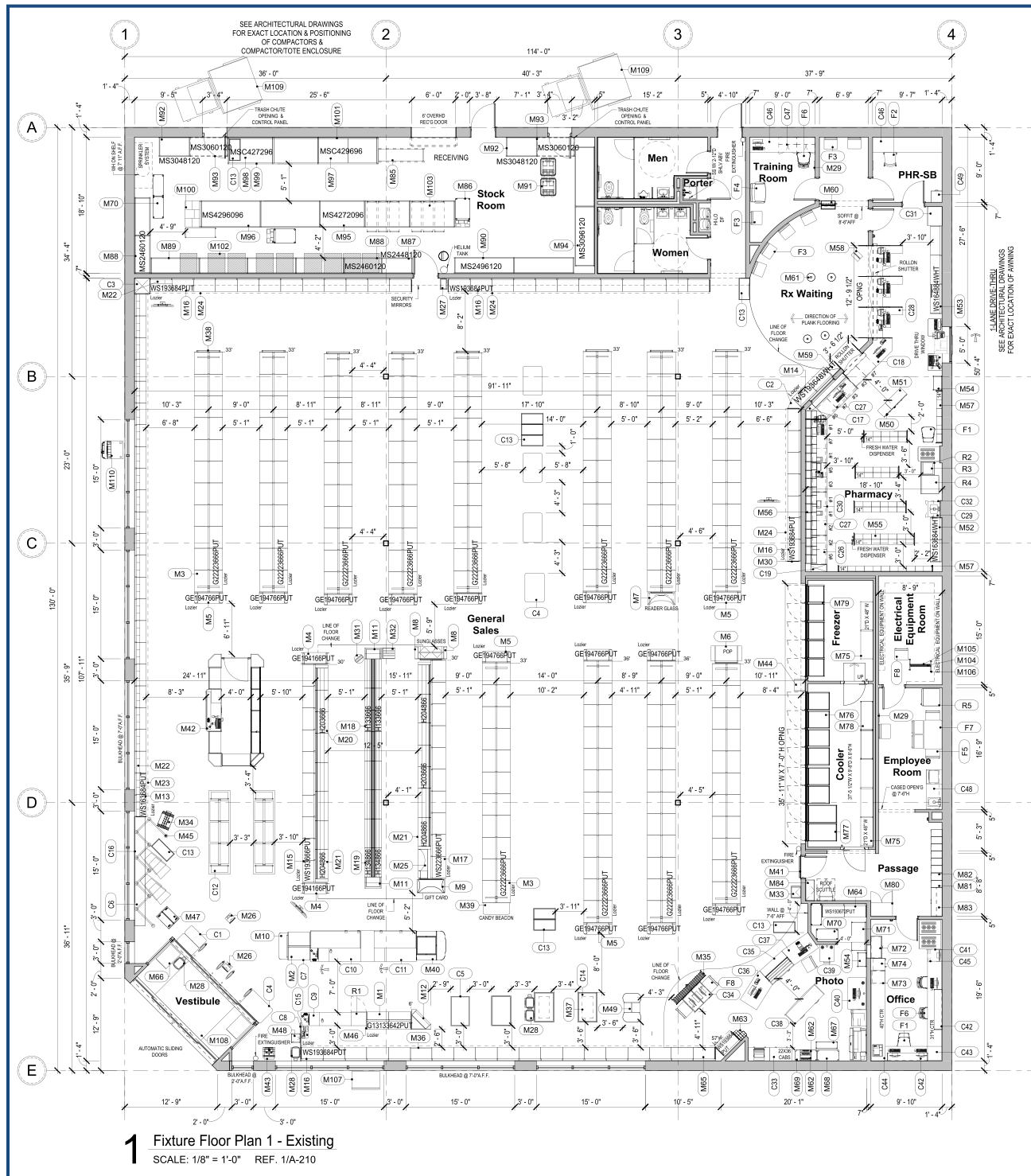

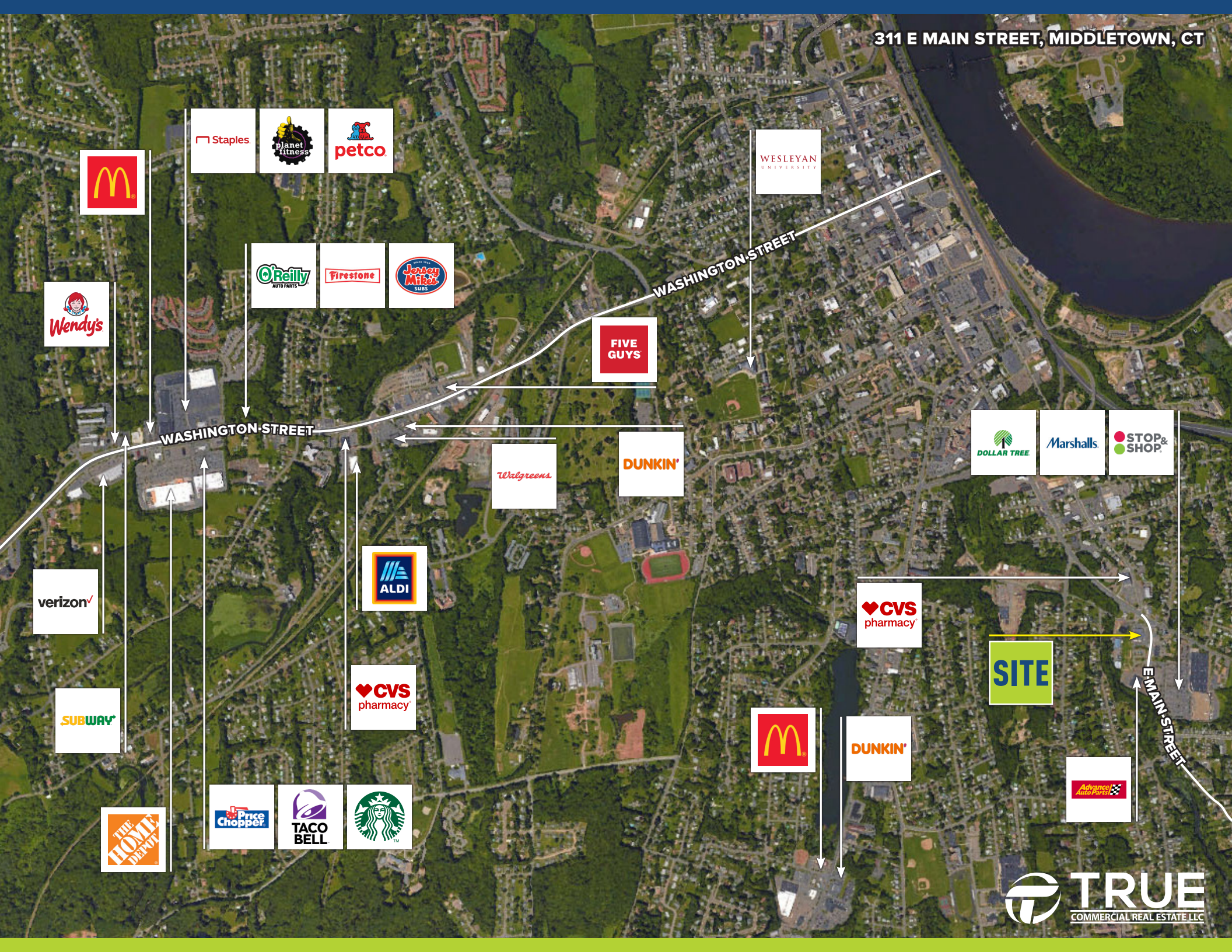

WASHINGTON STREET

WASHINGTON STREET

E MAIN STREET

