

TOWNE CENTRE

ROUTE 22 & ROUTE 312, BREWSTER, NY



DEMOGRAPHICS			
	3-Miles	5-Miles	7-Miles
Population	13,346	52,599	117,332
Number of Household	4,900	19,998	43,245
Avg. Household Income	\$170,259	\$156,635	\$144,541

FOR LEASE: 2,500 SF & 32,500 SF

DIVISIBLE

A TRUE EXCLUSIVE...
**CALL FOR THE
DETAILS!**

AGENTS:
DOMINICK MUSILLI
203.529.4629
dm@truecre.com

RICHARD SCHNIDER
203.762.6173
rs@truecre.com

This information provided in this marketing package has been obtained from sources believed reliable, but has not been verified for accuracy or completeness. You should conduct a careful, independent investigation of the property and verify all information. Any reliance on this information is solely at your own risk.



**TOWNE CENTRE
ROUTE 22 & ROUTE 312, BREWSTER, NY**

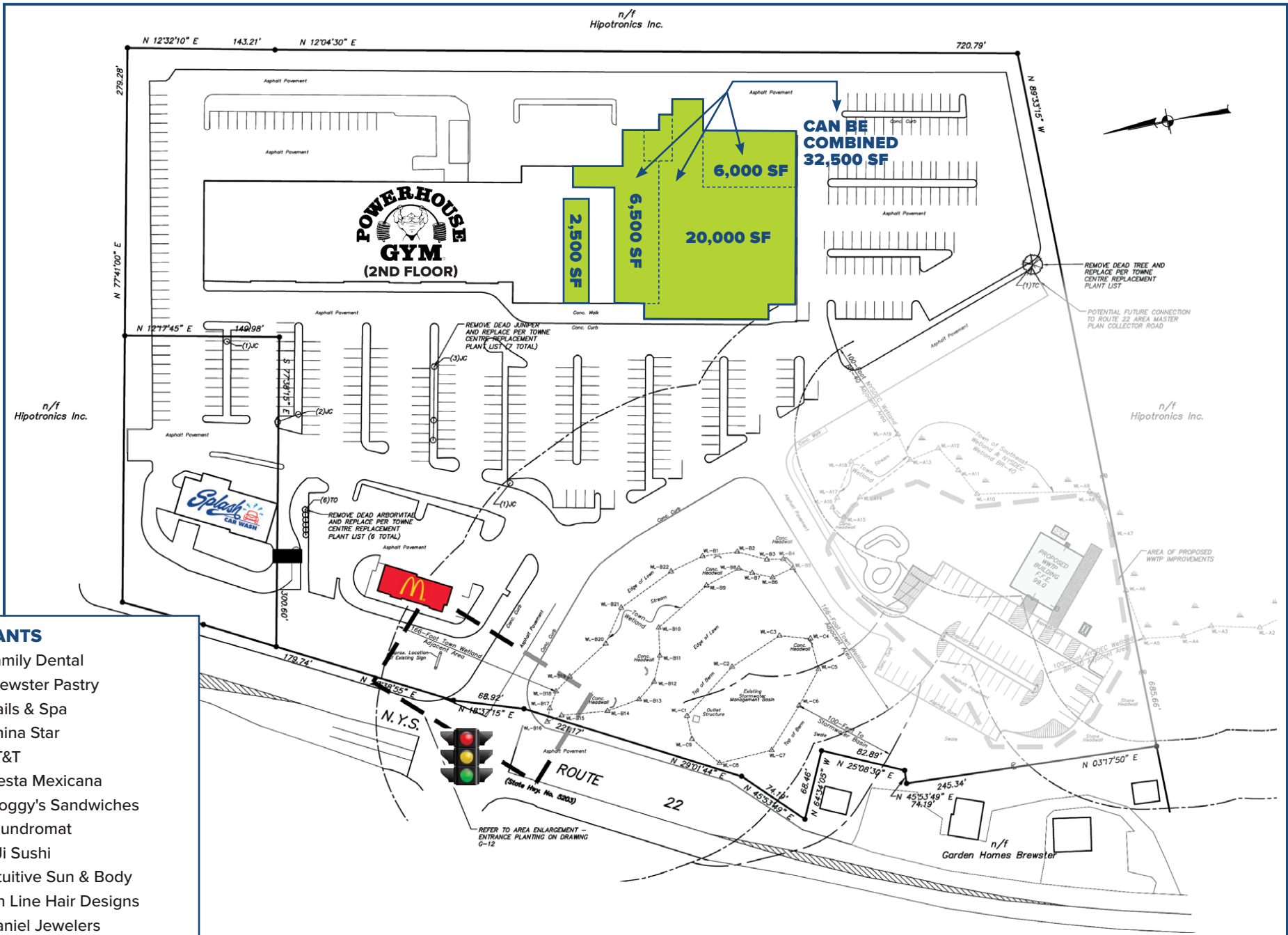

TENANTS

- 1 Family Dental
- 2 Brewster Pastry
- 3 Nails & Spa
- 4 China Star
- 5 AT&T
- 6 Fiesta Mexicana
- 7 Froggy's Sandwiches
- 8 Laundromat
- 9 AJi Sushi
- 10 Intuitive Sun & Body
- 11 On Line Hair Designs
- 12 Daniel Jewelers
- 13 Cleaners
- 14 Aversano's Restaurant
- 15 Buy-Rite Liquors

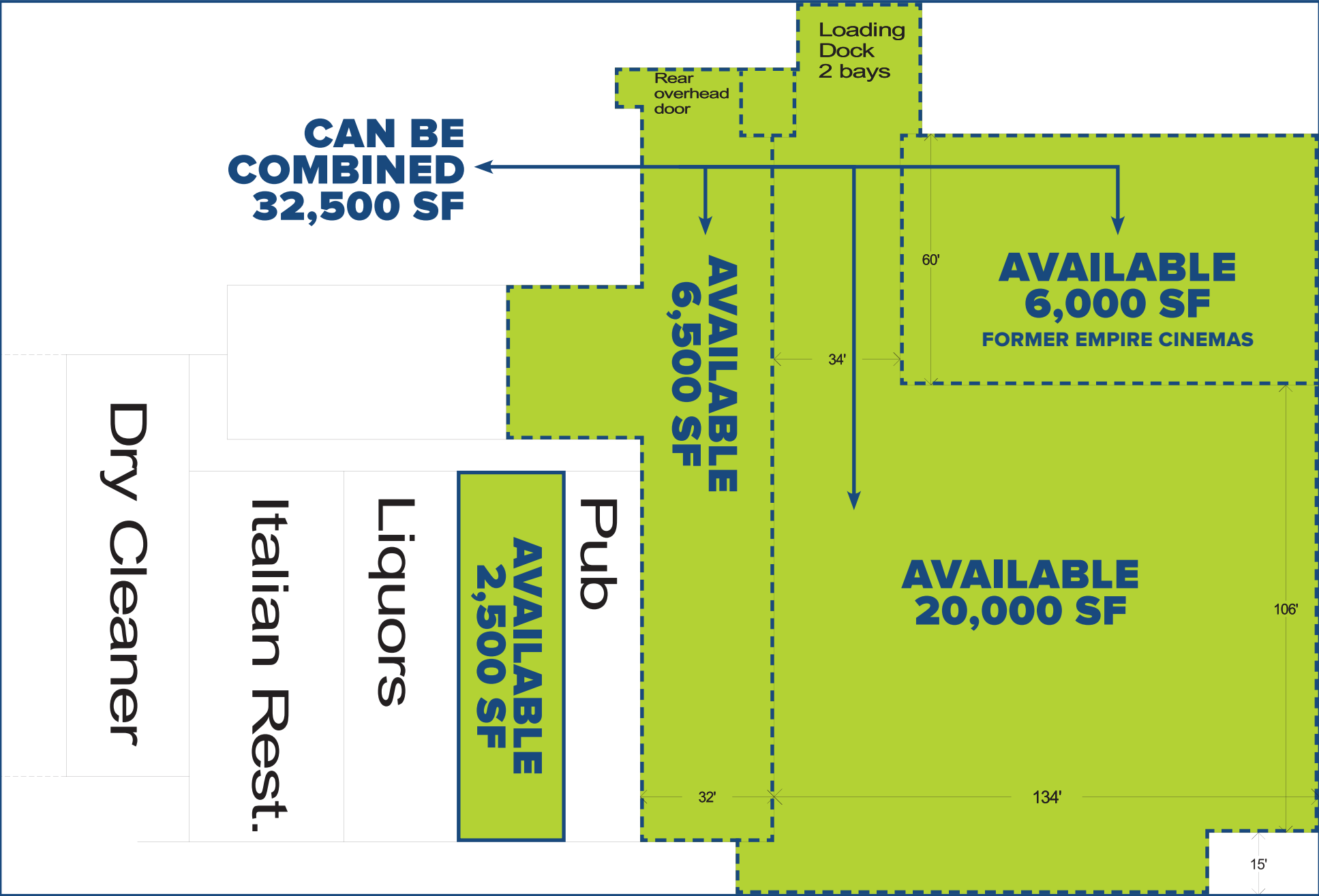

TOWNE CENTRE
ROUTE 22 & ROUTE 312, BREWSTER, NY



TOWNE CENTRE



LAKEVIEW SHOPPING CENTER



DANBURY GREEN

