

FOUNTAIN SQUARE

801 BRIDGEPORT AVENUE, SHELTON, CT



JOIN NEWLY SIGNED:
TRADER JOE'S

FOR LEASE:

1,200 SF - 2,663± SF PAD

Over 20,000 commuters per day travel to work in Shelton's 3,000,000± SF of retail, commercial and industrial businesses. Our new retail development is in the heart of the City, with a pedestrian connection to the nearby corporate parks and just minutes from Rt. 8, the main commuter route from Fairfield and New Haven counties!

AREA RETAILERS:

AND MANY MORE!

OPEN

DEMOGRAPHICS

	PRIMARY 3-MILE
Area Population	35,154
Households	14,448
Avg. Household Income	\$162,582
Total Businesses	2,658
Total Employees	31,278

25,000± VPD

A TRUE EXCLUSIVE...
**CALL FOR THE
DETAILS!**

AGENTS:
DOMINICK MUSILLI
203.529.4629
dm@truecre.com

TYLER LYMAN
203.529.4639
tl@truecre.com

This information provided in this marketing package has been obtained from sources believed reliable, but has not been verified for accuracy or completeness. You should conduct a careful, independent investigation of the property and verify all information. Any reliance on this information is solely at your own risk.



FOUNTAIN SQUARE
801 BRIDGEPORT AVENUE, SHELTON, CT





BEST-IN-CLASS ARCHITECTURE

Complimenting the built environment are extensive plantings, park benches, fountains, stone retaining walls and granite curbing.



OPEN



FULLY LEASED

**AVAILABLE
1,200 SF**

LEASE OUT

DENTIST

ROYAL NAIL SALON

**OASIS
CONVENIENCE**

**SportClips
HAIRCUTS**

**EUROPEAN
WAX
CENTER**

**FOUNTAIN SQUARE
WINE & LIQUOR**

**crumbl
cookies**

**sugar
llamas**

CLUB PILATES

CHOICE PET

**GOGI
KOREAN STEAKHOUSE & SUSHI**

mercato



FOUNTAIN SQUARE
801 BRIDGEPORT AVENUE, SHELTON, CT

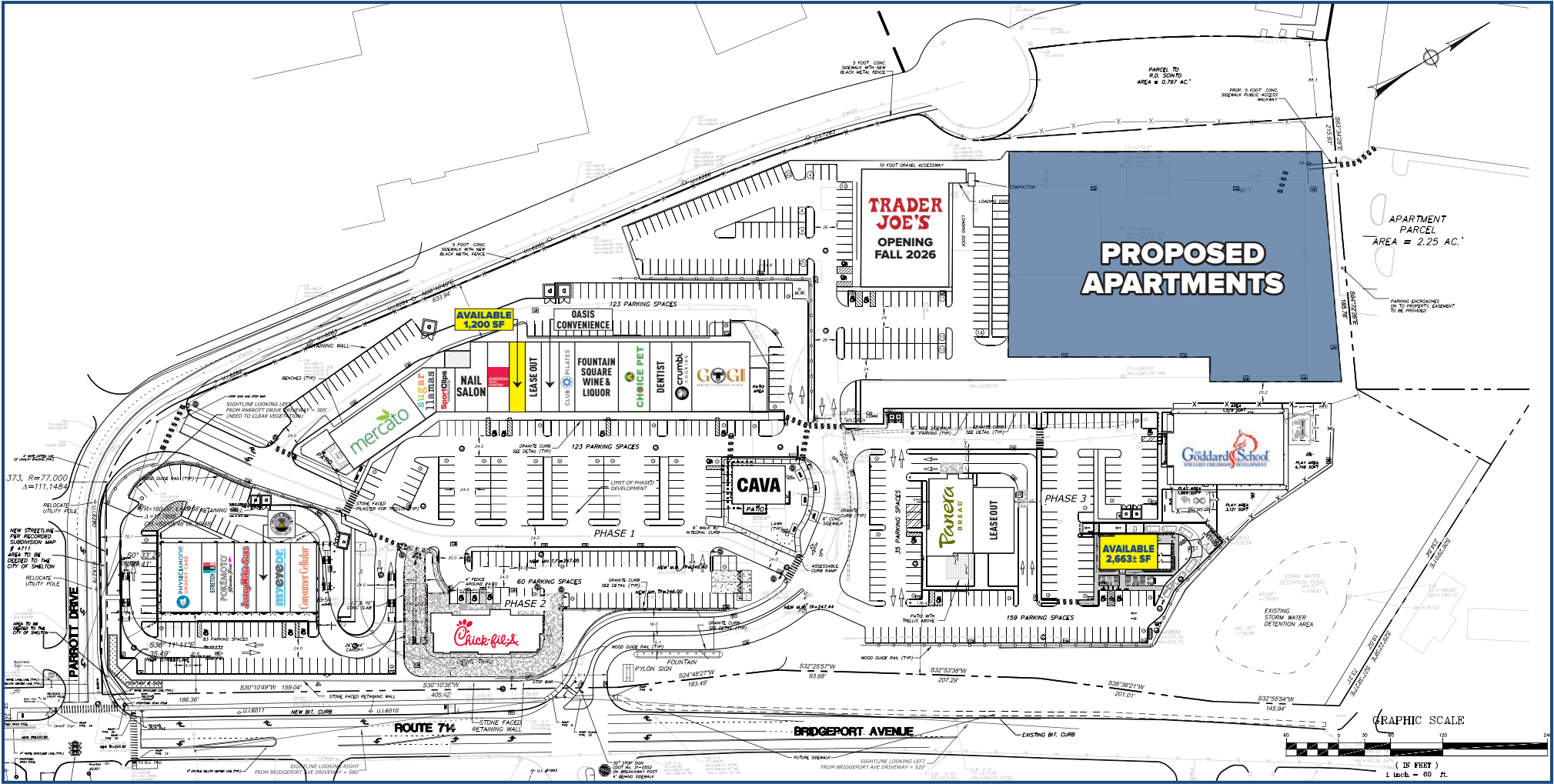

R.D. SCINTO
OFFICE PARK
& RESIDENCES
(2,000,000+ SF)

FOUNTAIN SQUARE

CAVA	TRAVIA BONES (FRUIT COYS)	Sport Clips (FRUIT COYS)	STRETCH LAB	mercato	Goldman Sachs	GOGI	Panera BREAD	Chick-fil-A	SITE
TRADER JOE'S OPENING FALL 2026	CHOICE PET	POKEMOTO	EUROPEAN WAX CENTER	myeyeDR.	PHYSICIAN MONITOR	Consumer Cellular	Jockey Antics	crumbl	

SHOPEX	FedEx	SIKORSKY
--------	-------	----------

WHIRLIGIG'S BAGELS	FIVE GUYS
--------------------	-----------

Starbucks	SPOTTED BIRD
-----------	--------------

Walmart

Bank of America

CHASE	PET SUPPLIES PLUS
-------	-------------------

BIG Y CENTER

Big Y	goodwill	BARRA	Great Clips	verizon
-------	----------	-------	-------------	---------

TJ-maxx

Webster Bank

Duchess

Allstate

Planet Fitness	Blue Lotus
----------------	------------

8
EXIT 11

COMMERCE DRIVE
16,300± ADT

BRIDGEPORT AVE-1-18,200± ADT

8
EXIT 13

BURGER KING

8
EXIT 12

Money

abc

Splash

SIKORSKY

SharpRate

CROWN POINT CENTERS

ups The UPS Store	enterprise	T-Mobile	DUNKIN'	Wendy's	verizon	SUBWAY
----------------------	------------	----------	---------	---------	---------	--------

STOP & SHOP	STOPSHOP gas	five BELOW	EDGE FITNESS CLUB	Hallmark	Hawley Lane SHOES
-------------	--------------	------------	-------------------	----------	-------------------

Staples

Walgreens	AT&T	MATTRESS FIRM	SPRINT BACK	PANCHEROS MEXICAN GRILL
OrangeTheory	OUTBACK STEAKHOUSE	GameStop	KUMON	TUTOR TIME

VONHOHN STEAKHOUSE	pepper's
--------------------	----------

TD Bank

DUNKIN'

BRIDGEPORT AVENUE
FROM ROUTE 8 / EXIT 11 TO ROUTE 8 / EXIT 13
DISTANCE: 4 MILES